

## Contact point

Special contact point for measuring instruments with shank thread M 2,5x0,45.

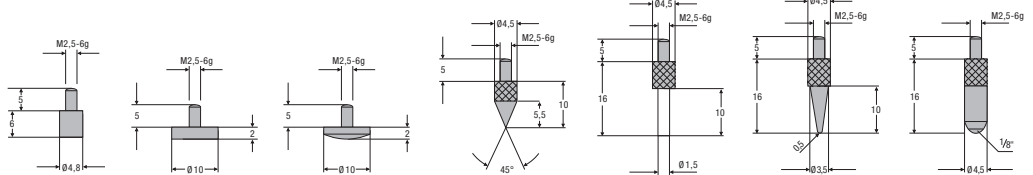

Final Code	Material	F05865	F05870	F05875	F05880	F05885	F05890	F05895
0005	Steel	◆	◆	◆	◆	◆	◆	◆
0010	Hard metal	◆	◆	◆	◆	◆	◆	◆
0015	Ruby							◆
0020	Sapphire							◆

## Contact point

Special contact point for measuring instruments with shank thread M 2,5x0,45.

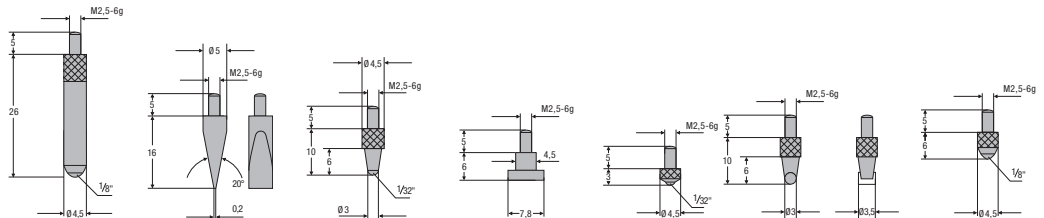

Final Code	Material	F05910	F05920	F05925	F05930	F05935	F05940	F05945
0005	Steel	◆	◆	◆	◆	◆	◆	◆
0010	Hard metal	◆	◆	◆	◆	◆	◆	◆
0015	Ruby							◆
0020	Sapphire							◆

## Contact point

Special contact point for measuring instruments with shank thread M 2,5x0,45.

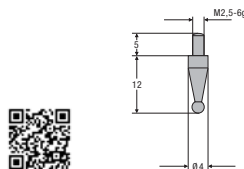

Code	€	Ø ball (mm)
F059070005	◆	1
F059070010	◆	1,5
F059070015	◆	2
F059070020	◆	2,5
F059070025	◆	3
F059070030	◆	3,5

Code	€	Ø ball (mm)
F059070035	◆	4
F059070040	◆	4,5
F059070045	◆	5
F059070050	◇	5,5
F059070055	◆	6
F059070060	◆	6,5

## Contact point

Special contact point for measuring instruments with shank thread M 2,5x0,45.

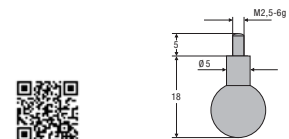

Code	€	Ø ball (mm)
F059150005	◆	7
F059150010	◇	7,5
F059150015	◆	8
F059150020	◇	8,5
F059150025	◆	9

Code	€	Ø ball (mm)
F059150030	◇	9,5
F059150035	◆	10
F059150040	◇	10,5
F059150045	◆	11

## Extension for comparators

Extension for comparators with a M 2.5x0.45 thread.

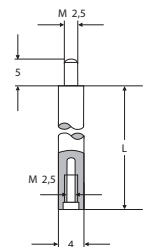

Code	€	Length L (mm)
F156400005	◇	10
F156400010	◇	15
F156400015	◇	20
F156400020	◇	25
F156400025	◇	30

Code	€	Length L (mm)
F156400030	◇	35
F156400035	◇	40
F156400040	◇	45
F156400045	◇	50
F156400050	◇	55

Code	€	Length L (mm)
F156400055	◇	60
F156400060	◇	65
F156400065	◇	70
F156400070	◇	75
F156400075	◇	80

Code	€	Length L (mm)
F156400080	◇	85
F156400085	◇	90
F156400090	◇	95
F156400095	◇	100